

<http://www.tingenplace.com>

CASTLE CREEK REALTY
PRESENTS:

65 CROSS ROADS CT

LOT # 3 6



HOLLY PLACE III

\$169,900

- 1670 SQUARE FEET
- 3 BEDROOMS
- 2 1/2 BATHS
- FIREPLACE
- KITCHEN WITH SMOOTH-TOP RANGE & MICROWAVE
- BUILT-IN DISHWASHER
- PANTRY
- LARGE DINING AREA.
- SPACIOUS LAUNDRY ROOM
- 2-CAR GARAGE
- MASTER SUITE WITH WALK-IN CLOSET, LUXURY BATH WITH GARDEN TUB/SHOWER, .
- CATHEDRAL CEILING



Builder is offering up to \$3,000 in closing costs with use of preferred attorney



Imagine relaxing in your spacious family room in front of the fireplace on those cold, winter nights. At the end of your day, relax in your master suite with walk-in closet, and bath with garden tub/shower. Do you like to cook? Then you will love the kitchen with smooth-top range, built in microwave, and pantry closet. Come home to Holly Place III in Tingen Place today!

Information deemed reliable, but not guaranteed.

<http://www.tingenplace.com>

CASTLE CREEK REALTY
PRESENTS:

65 CROSS ROADS CT

LOT # 3 6



HOLLY PLACE III



FIRST FLOOR

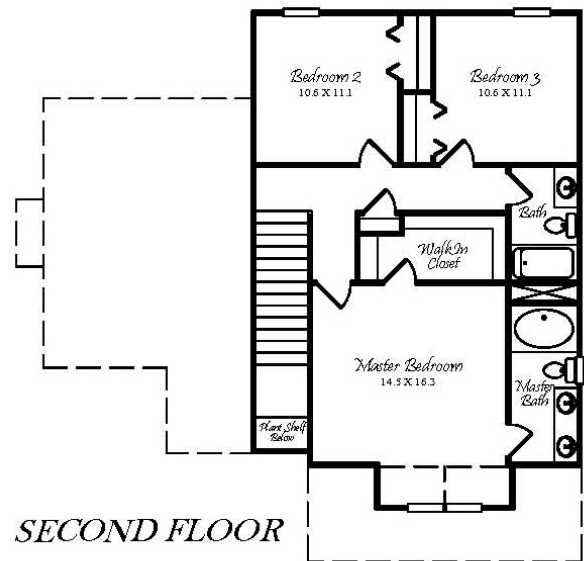

SECOND FLOOR

The logo for Castle Creek Realty, featuring a stylized castle tower with a red flag on top, set against a background of blue and green waves.

Castle Creek
Realty
CastleCreekRealEstate.com

Call us at

910-242-9030

For more information